

### FLEX-PRO® A2P

Specially designed for Pools, Spas,  
and Water Parks  
Feed Rates to 15.9 GPH (60.2 LPH)  
Pressures to 50 PSI  
100:1 Turndown ratio  
Tube Failure Detection System  
Variable Speed DC Motor  
2 Year Warranty



Certified to  
NSF/ANSI Standard 50

Exclusive:

**NEMA 4X**



Patents: 4,496,295, 7,001,153, 7,284,964 and other patents pending



#### Features:

- Peristaltic pump design does not have valves that can clog requiring maintenance.
- Self priming - even against maximum line pressure. Bypass valves are not required. Cannot vapor lock or lose prime.
- Output rates to: 15.9 GPH (60.2 LPH) and pressures up to 50 PSI (3.4 Bar).
- Variable speed DC motor.
- Patented Tube Failure Detection (TFD) system. Senses tube failure by detecting chemical in the pump head. No false triggering.
- Remote Start/Stop: Non-powered dry contact closure for remote start/stop.
- Outputs include: one 250V/3A relay to monitor TFD (Tube Failure System) and FVS (Flow Verification System).
- Two PVDF molded squeeze rollers and two alignment rollers for optimum squeeze, unparalleled accuracy, and tube life.
- Heavy duty rotor - single piece plastic rotor means no flexing and increased accuracy with no metal springs or hinges to corrode.
- Chemically resistant tubing capable of pumping bleach (sodium hypochlorite), calcium hypochlorite 20%, and muriatic acid (hydrochloric acid).

### Engineering Specifications:

**Maximum working pressure (excluding pump tubes):**

50 psig (3.4 bar)

Note: see individual pump tube assembly maximum pressure ratings.

**Maximum suction lift:**

30 ft. of water at sea level (14.7 atm psi)

**Ambient Operating Temperature**

14°F to 125°F (-10°C to 52°C)

**Ambient Storage Temperature**

-40°F to 158°F (-40°C to 70°C)

**Operating Voltage:**

115VAC 50/60Hz, 1ph (1.5 Amp Maximum)

230VAC 50/60Hz, 1ph (0.7 Amp Maximum)

220VAC 50/60Hz, 1ph (1.0 Amp Maximum)

240VAC 50/60Hz, 1ph (1.0 Amp Maximum)

**Power Cord Options:**

115V50/60Hz = NEMA 5/15 (USA)

230V50/60Hz = NEMA 6/15 (USA)

220V50/60Hz = CEE 7/VI (EU)

240V50/60Hz = AS 3112 (Australia/New Zealand)

**Motor:**

Brushed DC, 1/8 H.P.

**Duty cycle:**

Continuous

**Motor speed adjustment range 100:1:**

1.0% - 100% motor speed (1.3 to 130 RPM)

**Enclosure:**

NEMA 4X (IP66), Polyester powder coated aluminum.

Maximum Overall Dimensions:

7-1/2" W x 10-1/4" H x 14" D (19 W x 26 H x 35.6 D cm)

**Product weight:**

28.4 lb. (12.9 Kg)

**Approximate shipping wt:**

35 lb. (15.9 Kg)

### Materials of Construction:

**Wetted components:****Pump Tube Assembly (Model Specific - 2 provided):**

**Tubing:** . . . . . Flex-A-Prene

**Adapter fittings:** .PVDF

**Injection / Back-flow Check valve:**

**Body & insert:** . . . . . PVDF

**Check Ball:** . . . . . Ceramic

**Spring:** . . . . . Hastelloy C-276

**Ball Seat O-ring:** . . . . . FKM (optional EPDM)

**Static Seal O-ring:** . . . . . FKM (optional EPDM)

**Ancillary Items provided:**

**Suction Tubing:** . . . . . 3/8" OD x 1/4" ID x 10' Clear PVC

**Discharge Tubing:** . . . . . 3/8" OD x 1/4" ID x 10' Polyethylene (LLDPE)

**Suction Strainer:** . . . . . PVDF

**Non-Wetted components:****Enclosure:**

413 Aluminum (Polyester powder coated)

**Pump Head:**

Valox® (PBT) thermoplastic

**Pump Head Cover:**

Polycarbonate for added strength and chemical resistance.

Permanently lubricated sealed motor shaft support ball bearing.

**Cover Screws:**

Stainless Steel

**Roller Assembly:**

**Rotor:** .....Valox® (PBT)

**Rollers:** .....PVDF

**Roller Bearings:** .....SS Ball Bearings

**Motor Shaft:**

Chrome plated steel

**TFD System Sensor pins:**

Hastelloy C-276

**Power Cord:**

3 conductor, SJTW-A Water-resistant

**Tube Installation Tool:**

GF Nylon

**Mounting Brackets and Hardware:**

316 Stainless Steel

# FLEX-PRO® Peristaltic Metering Pump

## Engineering and Technical Data

### Output Specifications:

Feed Rate			Max Speed	Max Pressure	Max Temperature	A2P Model Numbers		
<b>Flex-A-Prene® A2P Tube Pumps</b>								
Meets FDA criteria for food   Excellent chemical resistance   CIP   SIP								
GPH	LPH	ML/Min	RPM	PSI (bar)	F (C)	115V AC	230V AC	220V AC
.055 - 5.5	.208 - 20.8	3.47 - 347	130	50 (3.4)	185 (85)	A2P24-SNEE	A2P25-SNEE	A2P26-SNEE
.159 - 15.9	.602 - 60.2	10.03 - 1003	130	40 (2.8)	185 (85)	A2P24-SNGG	A2P25-SNGG	A2P26-SNGG

• For optimum tube life, specify the pump to operate at the lowest possible RPM and pressure.

**A2P NGG**  
output at various RPM

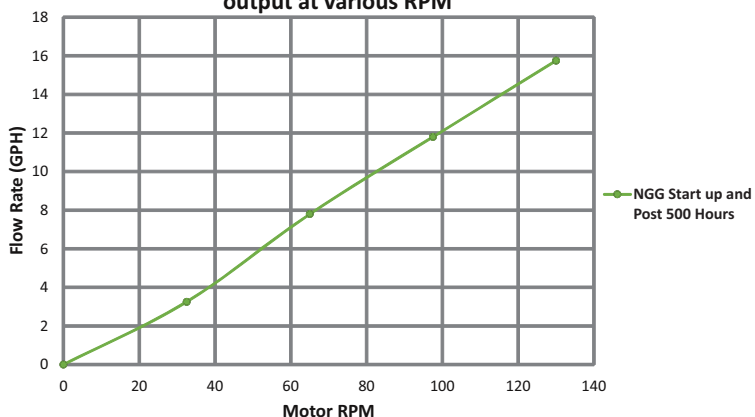

**A2P NEE**  
output at various RPM

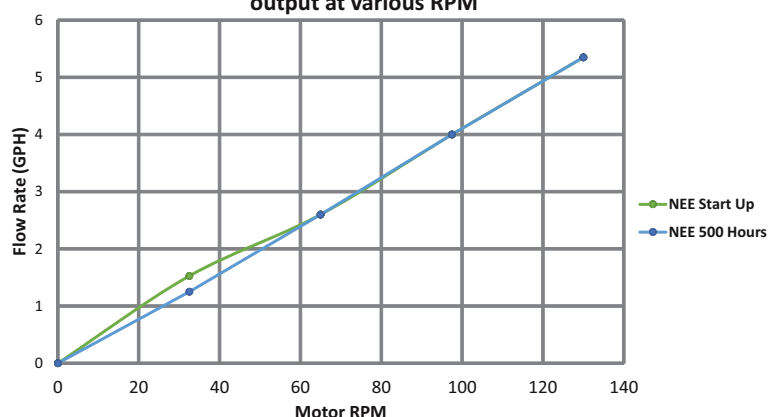

### Dimensions:

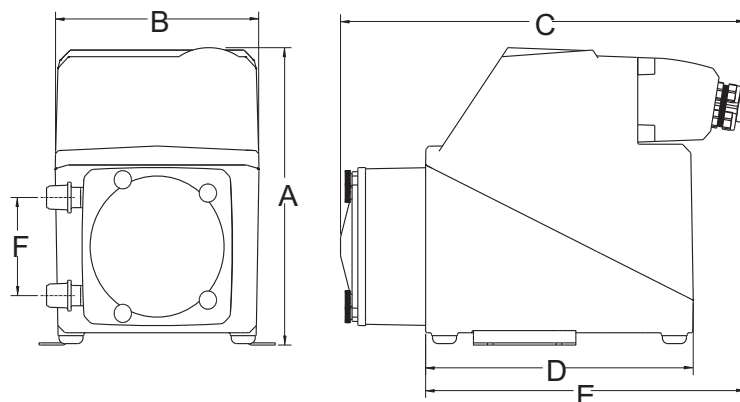

Dim	A2P Series	
	Inches	cm
A	10-1/4"	26
B	7-1/2"	19
C	14"	35.6
D	9-1/2"	24.1
E	11"	27.9
F	3-3/8"	8.6

# FLEX-PRO® Peristaltic Metering Pump

## Engineering and Technical Data

### Model Number Matrix:

Flex-Pro Model Number	
<b>A2P</b>	Flex-Pro Peristaltic Metering Pump
<b>Maximum Motor Speed</b>	
<b>2</b>	130 RPM (maximum rotor rotation speed)
<b>Power Cord (operating voltage requirement 96VAC to 264VAC)</b>	
<b>4</b>	115V 50/60Hz, power cord NEMA 5/15 plug (US)
<b>5</b>	230V 50/60Hz, power cord NEMA 6/15 plug (US)
<b>6</b>	220V 50/60Hz, power cord CEE 7/V11 plug (EU)
<b>8</b>	240V 50/60Hz, power cord AS 3112 plug (Australia/New Zealand)
<b>9</b>	230V 50/60Hz, power cord BS 1363/A plug (United Kingdom)
<b>X</b>	No Power Cord
<b>Pump Tube Material, Pump Tube Size, operating flow range</b>	
<b>NEE</b>	Flex-A-Prene® .093 ID, 0.055 to 5.5 GPH
<b>NGG</b>	Flex-A-Prene® .187 ID, 0.16 to 15.9 GPH

<b>A2P</b>	<b>2</b>	<b>4</b>	<b>-</b>	<b>S</b>	<b>NGG</b>	<b>Sample Model Number</b>
------------	----------	----------	----------	----------	------------	----------------------------